

SKETCH AND DESCRIPTIONS FOR  
**THE RESERVE AT SWEETWATER ESTUARY**  
SECTION 22, 23, 26, AND 27, TOWNSHIP 7 SOUTH, RANGE 7 EAST,  
TAYLOR COUNTY, FLORIDA

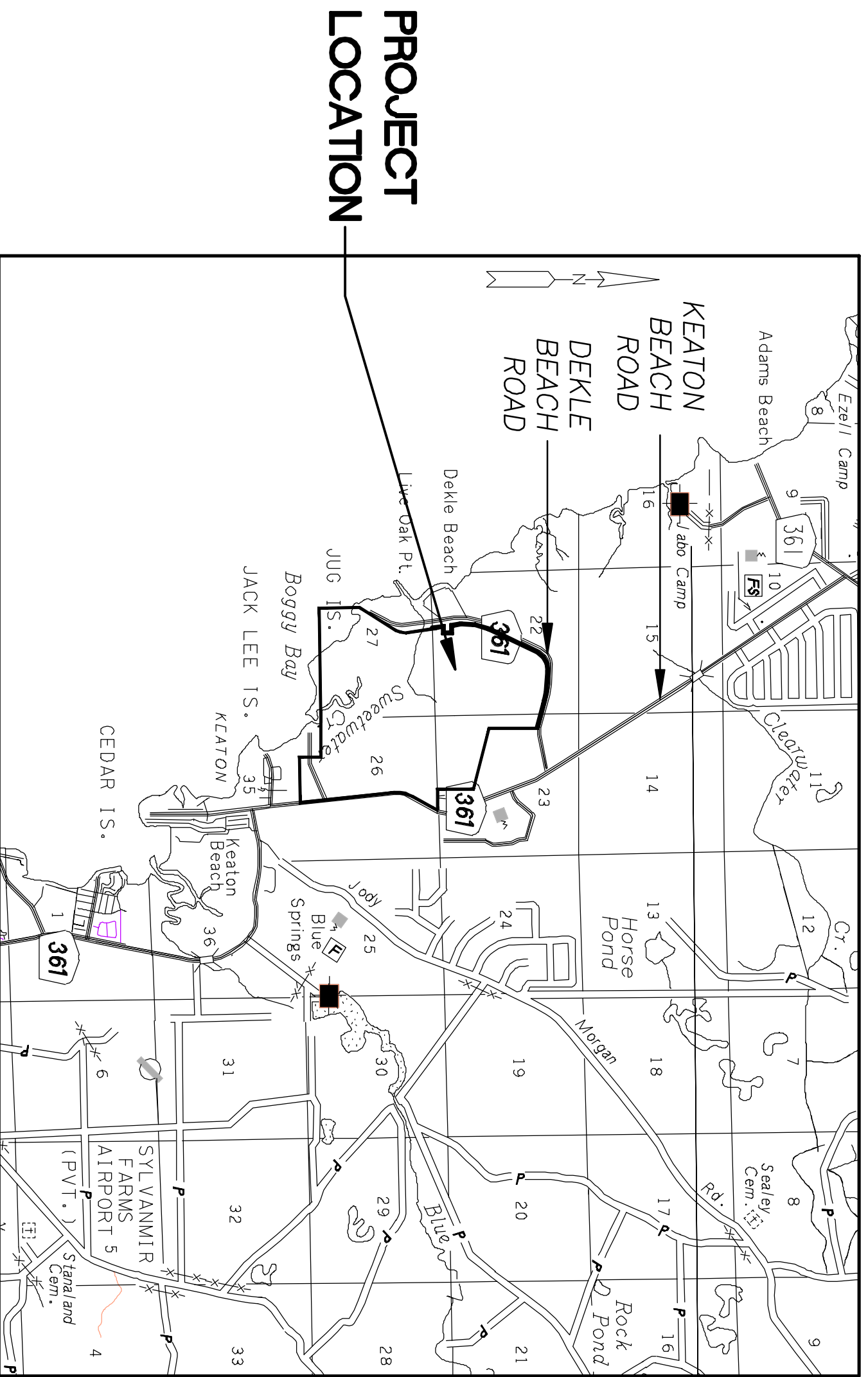
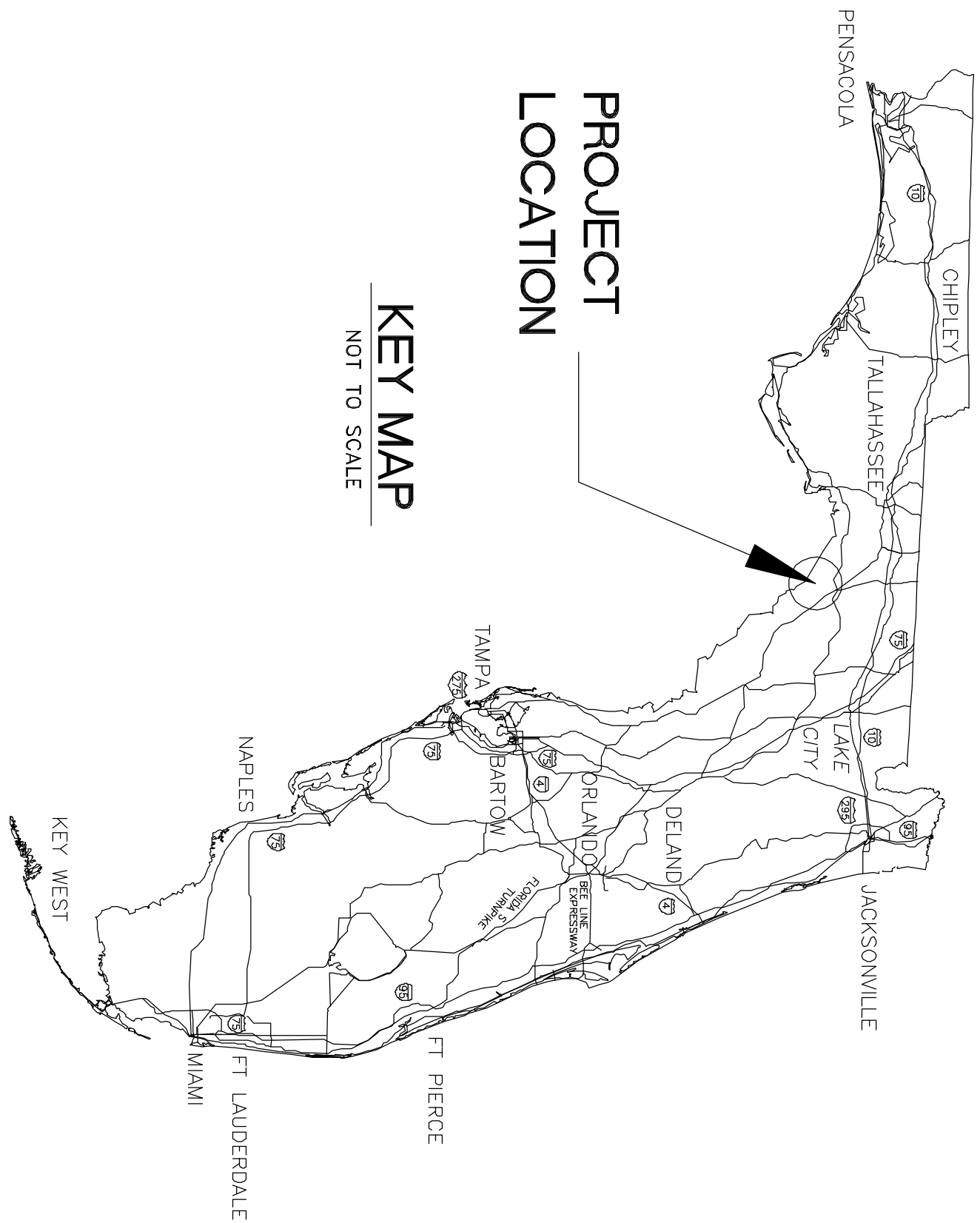

INDEX	COVER SHEET	SHEET 1
PROJECT LOCATION	COLOR INDEX MAP	SHEET 2 - 3
LEGAL DESCRIPTION	LEGAL DESCRIPTION	SHEET 4-6
DEVELOPMENT SUBAREA	DEVELOPMENT SUBAREA	SHEET 7-8
OPEN SPACE SUBAREA (PARCEL 1A)	OPEN SPACE SUBAREA (PARCEL 1A)	SHEET 9-10
OPEN SPACE SUBAREA (PARCEL 1B)	OPEN SPACE SUBAREA (PARCEL 1B)	SHEET 11
OPEN SPACE SUBAREA (PARCEL 1C)	OPEN SPACE SUBAREA (PARCEL 1C)	SHEET 12
OPEN SPACE SUBAREA (PARCEL 1D)	OPEN SPACE SUBAREA (PARCEL 1D)	SHEET 13
OPEN SPACE SUBAREA (PARCEL 1E)	OPEN SPACE SUBAREA (PARCEL 1E)	SHEET 14
OPEN SPACE SUBAREA (PARCEL 1F)	OPEN SPACE SUBAREA (PARCEL 1F)	SHEET 15-16
OPEN SPACE SUBAREA (PARCEL 1G)	OPEN SPACE SUBAREA (PARCEL 1G)	SHEET 17-18
OPEN SPACE SUBAREA (PARCEL 1H)	OPEN SPACE SUBAREA (PARCEL 1H)	SHEET 19-20
CONSERVATION SUBAREA (PARCEL 2A)	CONSERVATION SUBAREA (PARCEL 2A)	SHEET 21-22
CONSERVATION SUBAREA (PARCEL 2B)	CONSERVATION SUBAREA (PARCEL 2B)	SHEET 23-24
CONSERVATION SUBAREA (PARCEL 2C)	CONSERVATION SUBAREA (PARCEL 2C)	SHEET 25-26
CONSERVATION SUBAREA (PARCEL 2D)	CONSERVATION SUBAREA (PARCEL 2D)	SHEET 27-28
GOLF COURSE SUBAREA	GOLF COURSE SUBAREA	SHEET 29-31

- NOTES:**
1. BASIS OF BEARINGS: THE SOUTHERLY LINE OF SECTION 26, TOWNSHIP 7 SOUTH, RANGE 7 EAST, TAYLOR COUNTY, FLORIDA, BEING S89°17'7"W, FLORIDA STATE PLANE COORDINATE SYSTEM, MERIDIAN WEST ZONE.
  2. DISTANCES SHOWN ARE GROUND DISTANCES.
  3. THIS SURVEY IS NOT VALID WITHOUT THE SIGNATURE AND THE ORIGINAL RAISED SEAL OF A FLORIDA LICENSED SURVEYOR / MAPPER.
  4. THIS SKETCH WAS PREPARED WITHOUT THE BENEFIT OF AN ABSTRACT OR OPINION OF TITLE. NO INSTRUMENTS OF RECORD REFLECTING EASEMENTS, RIGHTS-OF-WAY, AND/OR OWNERSHIP WERE FURNISHED TO THIS SURVEYOR EXCEPT AS NOTED. THERE MAY BE ADDITIONAL EASEMENTS, RESTRICTIONS AND/OR OTHER MATTERS NOT SHOWN HEREON WHICH MAY BE FOUND IN THE COUNTY PUBLIC RECORDS.
  5. UNDERGROUND UTILITIES AND FOUNDATIONS, IF ANY, NOT LOCATED.
  6. THIS IS NOT A BOUNDARY SURVEY.
  7. THIS SKETCH IS BASED ON A BOUNDARY SURVEY ENTITLED "BOUNDARY SURVEY FOR J. CRAYTON FRUIT, SECTIONS 9, 11, 14, 15, 16, 21, 22, 23, 26 & 27, TOWNSHIP 7 SOUTH, RANGE 7 EAST, TAYLOR COUNTY, FLORIDA," DATED 03/20/08, AND A REVISION DATED 03/20/08, PREPARED BY W.H. RAULUF, P.L.S.
  8. THE "LEGAL DESCRIPTION" HEREON WAS PREPARED BY THE SURVEYOR PER THE CLIENT'S REQUEST.
  9. THIS MAP IS INTENDED TO BE DISPLAYED ON SHEET SIZE 24"x36" OTHER SIZE PRINTS WILL NOT BE TO SCALE.

I hereby certify that the attached "SKETCH OF DESCRIPTION" of the herein-described property is true and correct to the best of my knowledge, information and belief as of the date hereof, and that the same meets the minimum technical standards set forth in rule 61G7-6 of the Florida Administrative Code.

SIGNED: **RALPH A. NIETO**  
FLA PROFESSIONAL SURVEYOR/MAPPER #6025

REV#	DATE	DESCRIPTION	BY
1	10/31/08	ADD SHEETS, RENUMBER PLAN SET AND PARCELS	TAS

NOT VALID FOR CONSTRUCTION UNLESS SIGNED AND DATED:

1410 LPGA Blvd., Suite 148  
Daytone Beach, FL 32117  
386.274.1600 FAX: 386.274.1602  
Certificate of Authorization No.: 3592  
www.wadetrिम.com/tomoka

Building relationships on a foundation of excellence

COVER SHEET  
SECTION 22, 23, 26 AND 27  
TOWNSHIP 7 SOUTH, RANGE 7 EAST  
**THE RESERVE AT SWEETWATER ESTUARY**

ISSUED FOR: DATE: BY:  
PRELIM 10/31/08 TAS  
JOB NO. ZZZ2299.05M  
SHEET 1 OF 31



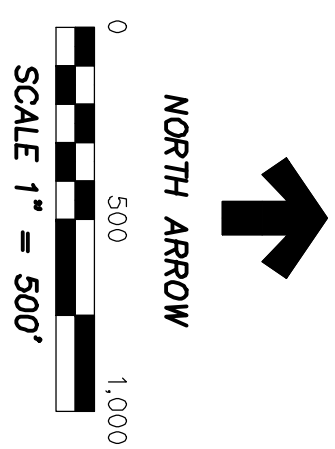

SKETCH AND DESCRIPTIONS FOR  
**THE RESERVE AT SWEETWATER ESTUARY**  
 SECTION 22, 23, 26, AND 27, TOWNSHIP 7 SOUTH, RANGE 33 EAST,  
 TAYLOR COUNTY, FLORIDA

**LEGEND and ABBREVIATIONS**

L.S.	LOCATED SURVEYOR	M.B.	MAP BOOK
R/W	RIGHT-OF-WAY	R.C.D.	RECORDED DATA
(O&B)	OFFICIAL RECORDS BOOK	SEC	SECTION
R	RANGE	R/W	RANGE
T	TOWNSHIP	(RED)	RECORDED DATA
D	DEED	S&Z	SQUARE FEET
CB	CHORD BEARING	SEC	SECTION
(C)	CALCULATED DATA	R/W LINE	RANGE
TP	TRIPK	NON-TANGENT	NON-TANGENT

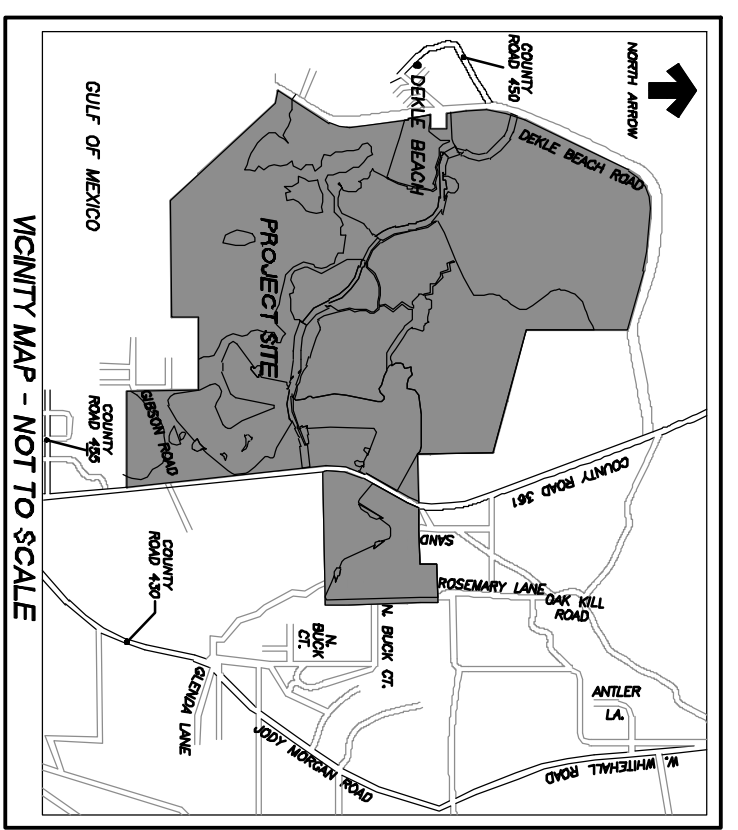
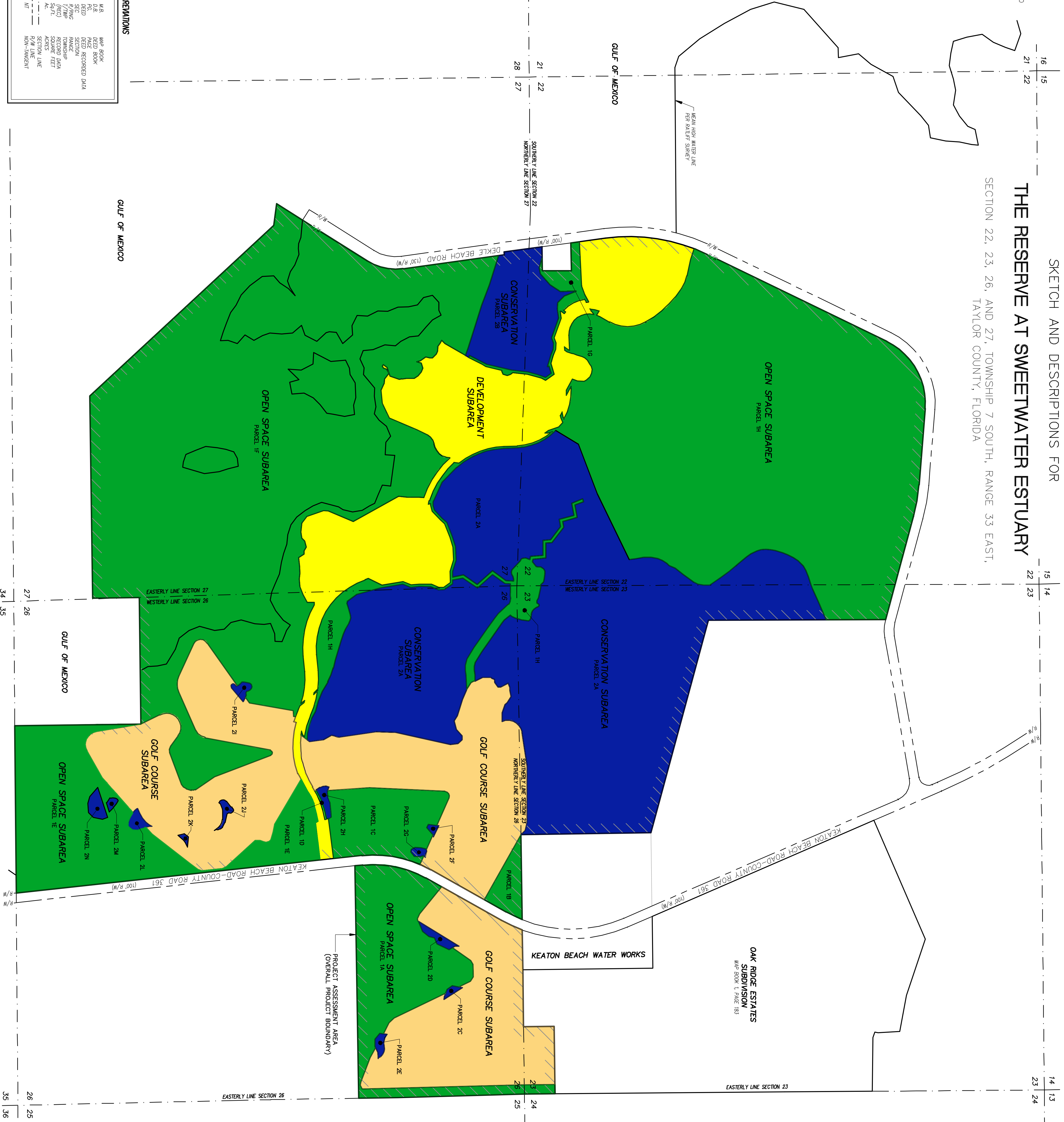

- PROPOSED SWEETWATER RESORT  
 LAND USE DEVELOPMENT AREAS**
- PROJECT ASSESSMENT AREA
  - DEVELOPMENT SUBAREA
  - OPEN SPACE SUBAREA
  - CONSERVATION SUBAREA
  - GOLF COURSE SUBAREA

- 1) Project Assessment Area:  
1169,58 ac. 50,946,952 s.f.
- 2) Development Subarea:  
56,25 ac. 4,149,256 s.f.
- 3) Open Space Subarea:  
62,02 ac. 28,402,089 s.f.
- 4) Conservation Subarea:  
256,61 ac. 11,171,766 s.f.
- 5) Golf Course Subarea:  
163,70 ac. 7,217,127 s.f.

THIS MAP IS INTENDED TO BE DISPLAYED AT A SCALE OF 1"=500' ON SHEET SIZE 24"x36". OTHER SIZE PRINTS WILL NOT BE TO SCALE.  
 SEE SHEET 1 FOR NOTES AND SIGNATURE BLOCK

JOB NO. <b>ZZ22299.05M</b>	SHEET <b>3 OF 31</b>	<b>INDEX MAP</b> SECTION 22, 23, 26 AND 27 TOWNSHIP 7 SOUTH, RANGE 7 EAST <b>THE RESERVE AT SWEETWATER ESTUARY</b>	NOT VALID FOR CONSTRUCTION UNLESS SIGNED AND DATED:  1410 LPGA Blvd., Suite 148 Daytona Beach, FL 32117 386.274.1600 FAX: 386.274.1802 Certificate of Authorization No.: 3592 www.wadetrिम.com/tomoka	<table border="1" style="width: 100%; border-collapse: collapse;"> <thead> <tr> <th>REV#</th> <th>DATE</th> <th>DESCRIPTION</th> <th>BY</th> </tr> </thead> <tbody> <tr> <td>1</td> <td>10/31/08</td> <td>ADD SHEETS, RENUMBER PLAN SET AND PARCELS</td> <td>TAS</td> </tr> </tbody> </table>	REV#	DATE	DESCRIPTION	BY	1	10/31/08	ADD SHEETS, RENUMBER PLAN SET AND PARCELS	TAS
REV#	DATE	DESCRIPTION	BY									
1	10/31/08	ADD SHEETS, RENUMBER PLAN SET AND PARCELS	TAS									